



ORDINANCE NO. 2021- 4

**AN ORDINANCE ANNEXING REAL
PROPERTY/TERRITORY TO THE CITY OF CLAREMORE,
OKLAHOMA, AS MORE PARTICULARLY DESCRIBED HEREIN**

WHEREAS, the City of Claremore (the "City") has received a petition to annex real property/territory to the City (the "Petition"). A copy of the Petition is attached as Exhibit "1"; and

WHEREAS, the legal description of the real property/territory proposed to be annexed to the City is set out in the attached Exhibit "2" (the "Tract"); and

WHEREAS, the Tract is adjacent or contiguous to the City, per the provisions found in OKLA. STAT. tit. 11 21-102; and

WHEREAS, the Petition is signed by at least 3/4ths of the registered voters and by the owners of 3/4ths in value of the Tract (the "Owners") as required by OKLA. STAT. tit. 11 § 21-105; and

WHEREAS, the Owners have complied with the notice requirements of OKLA. STAT. tit. 11 § 21-105 by publishing notice in the Claremore Progress on April 4, 2021 and April 11, 2021; and

WHEREAS, the City finds that it is desirable, beneficial and in the best interest of the City to annex the Tract to the City.

BE IT ORDAINED BY THE CITY COUNCIL OF THE CITY OF CLAREMORE, OKLAHOMA:

Section No. 1: That the Petition of the Owners is approved and that the Tract, more particularly described on the attached Exhibit "1", be annexed to the City of Claremore, Oklahoma, pursuant to the authority granted to the Council of the City of Claremore, Oklahoma by OKLA. STAT. tit. 11 § 21-105.

Section No. 2: That the City Clerk is hereby ordered and directed to cause this Ordinance to be published as required by law.

Section No. 3: That the City Clerk is further ordered and directed to file and record this Ordinance and the other documents as required by OKLA. STAT. tit. 11, § 21-112.

Passed and Approved by the Mayor and Council of the City of Claremore, Oklahoma, this

19th day of April, 2021.

ATTEST:

Sarah Sharp
City Clerk
[SEAL]



Bruce Hanagan
Mayor, City of Claremore, Oklahoma

CITY OF CLAREMORE
CITY CLERK
P.O. BOX 249
CLAREMORE, OK 74018-0249

Before The City of the City of Claremore, Oklahoma

PETITION TO ANNEX ADJACENT TERRITORY

Pursuant to OKLA. STAT. tit. 11, Section 21-105, Jeffrey R Reetz requests to the City Council of the City of Claremore, Rogers County, Oklahoma, a municipal corporation, to annex and make a part of said City, the real estate and property described as follows, to-wit:

LEGAL DESCRIPTION:

THE NORTH HALF (N/2) OF THE NORTHEAST QUARTER (NE/4) OF SECTION THIRTEEN (13), TOWNSHIP TWENTY-ONE (21) NORTH, RANGE FIFTEEN (15) EAST OF THE INDIAN BASE AND MERIDIAN., LESS THE EAST 1613.32 FEET THEREOF AND LESS THE NORTH 660 FEET OF THE WEST 405 FEET OF THE EAST 2018.32 FEET OF THE NORTH HALF (N/2) OF THE NORTHEAST QUARTER (NE/4) AND LESS THE WEST HALF (W/2) OF THE NORTHWEST QUARTER (NW/4) OF THE NORTHEAST QUARTER (NE/4) OF SECTION THIRTEEN (13), TOWNSHIP TWENTY-ONE (21) NORTH, RANGE FIFTEEN (15) EAST OF THE INDIAN BASE AND MERIDIAN, ROGERS COUNTY, OKLAHOMA, ACCORDING TO THE U.S. GOVERNMENT SURVEY THEREOF, BEING MORE PARTICULARLY DESCRIBED AS FOLLOWS:

COMMENCING AT THE NORTHEAST CORNER OF SAID SECTION THIRTEEN (13); THENCE SOUTH 88°39'21" WEST ALONG THE NORTH LINE OF THE NORTHEAST QUARTER (NE/4) OF SAID SECTION, A DISTANCE OF 2018.32 FEET TO THE POINT OF BEGINNING; THENCE SOUTH 01°23'46" EAST, A DISTANCE OF 660.00 FEET; THENCE NORTH 88°39'21" EAST, A DISTANCE OF 405.00 FEET; THENCE SOUTH 01°23'46" EAST, A DISTANCE OF 658.25 FEET; THENCE SOUTH 88°39'03" WEST, A DISTANCE OF 1024.43 FEET; THENCE NORTH 01°22'41" WEST, A DISTANCE OF 659.17 FEET; THENCE NORTH 88°39'12" EAST, A DISTANCE OF 329.72 FEET; THENCE NORTH 01°22'41" WEST, A DISTANCE OF 659.16 FEET TO THE NORTH LINE OF SAID NORTHEAST QUARTER (NE/4); THENCE NORTH 88°39'21" EAST ALONG SAID NORTH LINE, A DISTANCE OF 289.30 FEET TO THE POINT OF BEGINNING. CONTAINING 865,593 SQUARE FEET OR 19.87 ACRES.

Petitioner states that he is the owner of the property and that the property is adjacent and contiguous to the municipality of the City of Claremore.

Dated this 8th day of April, 2021.

Stephen Davison POA
Jeffrey R Reetz

CITY OF CLAREMORE
CITY CLERK
P.O. BOX 249
CLAREMORE, OK 74018-0249

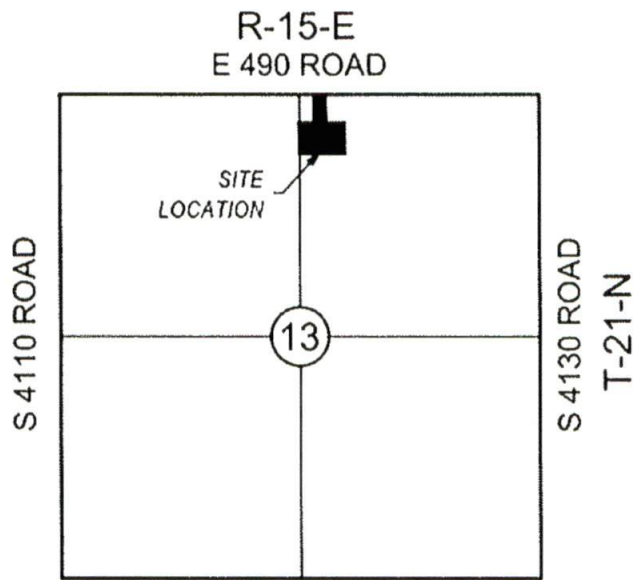

LOCATION MAP
SCALE: 1"=2000'

LEGAL DESCRIPTION

PER TITLE COMMITMENT:

THE NORTH HALF (N/2) OF NORTHEAST QUARTER (NE/4) OF SECTION THIRTEEN (13), TOWNSHIP TWENTY-ONE (21) NORTH, RANGE FIFTEEN (15) EAST OF THE I.B. &M., LESS THE EAST 1613.32 FEET THEREOF AND LESS THE NORTH 660 FEET OF THE WEST 405 FEET OF THE EAST 2018.32 FEET OF THE NORTH HALF (N/2) OF NORTHEAST QUARTER (NE/4) AND LESS THE WEST HALF (W/2) OF NORTHWEST QUARTER (NE/4) OF NORTHWEST QUARTER (NW/4) OF NORTHEAST QUARTER (NE/4) OF SECTION THIRTEEN (13), TOWNSHIP TWENTY-ONE (21) NORTH, RANGE FIFTEEN (15) EAST OF THE I.B.&M., ROGERS COUNTY, STATE OF OKLAHOMA, ACCORDING TO THE U.S. GOVERNMENT SURVEY THEREOF.

CITY OF CLAREMORE
CITY CLERK
P.O. BOX 249
CLAREMORE, OK 74018-0249